

5000 Series Linear Air Pumps

MAINTENANCE AND INSTALLATION INSTRUCTIONS

Read and understand the information and instructions included with this product before using. This information is for your safety and to prevent damage to this product. Failure to observe these safety precautions could result in severe bodily injury, including death in extreme cases.



CAUTION: To reduce risk of electrical shock...

1. Do not disassemble. Disassembly or attempted repairs if accomplished incorrectly can create electrical shock hazard. Refer servicing to qualified service agencies only.
2. If this pump assembly is supplied with a three-pronged plug, connect unit to a properly grounded outlet only.



WARNING: To reduce risk of electrocution...

1. This product should never be left unattended when plugged in.
2. Always unplug this product immediately after use and store in dry place.
3. Do not use this product in or near area where it can fall or be pulled into water or other liquids.
4. Do not reach for this product if it has fallen into liquid. Unplug immediately.
5. Never operate indoor-rated products outdoors in the rain or in a wet area.



DANGER: To reduce risk of explosion or fire...

1. Do not use this product in or near explosive atmospheres or where aerosol (spray) products are being used.
2. Do not pump anything other than atmospheric air.
3. Do not pump combustible liquids or vapors with this product or use in or near an area where flammable or explosive liquids or vapors may exist.
4. Do not use this product near flames.



CAUTION: To prevent Injury...

1. Close supervision is necessary when this product is used near children or invalids. Never allow children to operate unit.
2. Never operate this product if it has a damaged cord or plug, if it is not working properly, if it has been dropped or damaged, or if it has fallen into water. Return the product to a service center for examination and repair.
3. Keep the cord away from heated surfaces.
4. Never block any air openings (inlet) of this product or place it on a soft surface where the openings may be blocked. Keep all air openings free of lint, dirt and other foreign objects.
5. Never use while sleeping or drowsy.
8. Never drop or insert fingers or any other object into openings.
7. Do not operate this product where oxygen is being administered.
8. This unit may be thermally protected and can automatically restart when the protector resets. Always disconnect power source before servicing.
9. Wear safety glasses or goggles when operating this product.
10. Use only in well ventilated areas.
11. Do not use any tools or attachments without first determining maximum air pressure for that tool or attachment.
12. Never point any air nozzle or air sprayer toward another person or any part of the body.
13. All electrical products generate heat. To avoid serious burns never touch unit during or immediately after operation.

Grounding Instructions

This product should be grounded. In the event of an electrical short circuit, grounding reduces the risk of electric shock by providing an escape wire for the electric current. This product is equipped with a cord having a grounding wire with an appropriate grounding plug. The plug must be plugged into an outlet that is properly installed and grounded in accordance with all local codes and ordinances.



DANGER – Improper installation of the grounding plug can result in a risk of electric shock. If repair or replacement of the cord or plug is necessary, do not connect the grounding wire to either flat blade terminal. The wire with insulation having an outer surface that is green with or without yellow stripes is the grounding wire. Check with a qualified electrician or serviceman if the grounding instructions are not completely

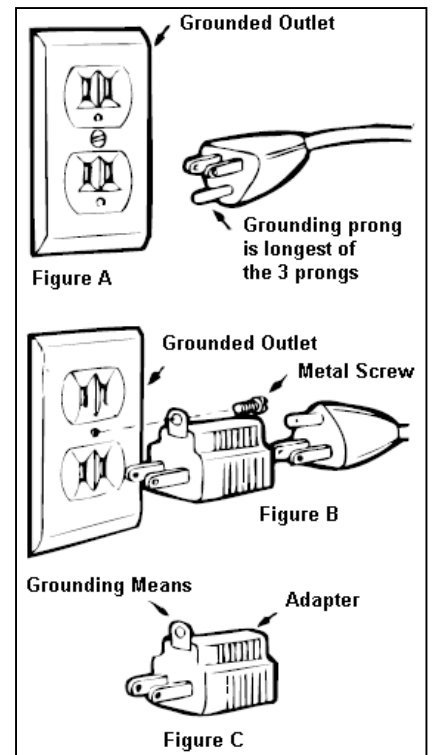

understood, or if in doubt as to whether the product is properly grounded. Do not modify the plug provided; if it will not fit the outlet, have the proper outlet installed by a qualified electrician. This product is for use on a nominal 120-volt circuit, and has a grounding plug that looks like the plug illustrated in Fig. A. A temporary adapter that looks like the adapter illustrated in Fig. B and Fig. C may be used to connect this plug to a 2-pole receptacle as shown in Fig. B, if a properly grounded outlet is not available. The temporary adapter should be used only until a properly grounded outlet (Fig. A) can be installed by a qualified electrician. The green colored rigid ear, lug, or the like extending from the adapter must be connected to a permanent ground such as a properly grounded outlet box cover. Whenever the adapter is used, it must be held in place by a metal screw. This adapter shown in Fig. B and Fig. C is not acceptable in Canada.

Extension Cords – Use only a 3-wire extension cord suitable for outdoor use that has a 3-blade grounding plug, and a 3-slot receptacle that will accept the plug on the product. Make sure your extension cord is in good condition. When using an extension cord, be sure to use one heavy enough to carry the current your product will draw. For lengths less than 25 feet, No. 18 AWG extension cords should be used. For lengths less than 100 feet, No. 16 AWG extension cords should be used. An undersized cord will cause a drop in line voltage resulting in loss of power and overheating. If in doubt, use the next heavier gage. The smaller the gage number, the heavier the cord.

Ambient Conditions – This unit should be operated in a well-ventilated area where the surrounding air is relatively clean, dry and temperatures are consistently within the range of 35°F (2°C) and 95°F (35°C). Adequate ventilation is required for proper operation.

Output Pressure - The pump should be operated within recommended output pressure. Pump life is shortened if operation outside of the specified pressure ranges occur.

Maintenance - The air filter should be cleaned every four months with detergent. The air filter should be changed every 12 months. A rebuild kit should be installed after every 18 - 24 months of operation. Refer to Thomas Products Division document #C50443 for detailed instructions on servicing 5030 through 5200S linear models. Contact the Thomas Products Division Service Department or your local Thomas Products Division Distributor for assistance if required.

Service Parts

Note: Service kits include base gasket, filter cover gasket (where appropriate), L-tubes (2), head & diaphragm assemblies (2), and intake filter.

Part Number	Description	Where Used
C56300	Air filter	5030-A, 5040-A, 5060-A & V models
C50318	Air filter	5078S, 5100S-C, 5120S
C56302	Air filter	5150S, 5200S
C56002	Gasket, filter cover	5078S, 5100S-C, 5120S
C56005	Gasket, filter cover	5150S, 5200S
C50283	Gasket, tank	5006, 5015, 5020 and V models
C56008	Gasket, tank	5030-A, 5040-A, 5060-A & V models
C50284	Gasket, tank	5078S, 5100S-C, 5120S
C50285	Gasket, tank	5150S, 5200S
C50279	Head & Diaphragm Assy (2 required)	5006, 5015, 5020, & MO, SE and V models
C50278	Head & Diaphragm Assy (2 required)	5030-A, 5040-A, MO & V models
C50276	Head & Diaphragm Assy (2 required)	5060-A, MO & V models
C50280	Head & Diaphragm Assy (2 required)	5078S, 5100S-C, 5120S, & SE models
C50281	Head & Diaphragm Assy (2 required)	5150S, 5200S
C50144	L-tube (2 required)	5006, 5015, 5020 and V models
C50554	L-tube (2 required)	5030-A, 5040-A, 5060-A & V models
C53900	L-tube (2 required)	5078S, 5100S-C, 5120S
C53903	L-tube (2 required)	5150S, 5200S
C50401-P	Service kit	5030-A, 5040-A, MO & V models
C50397-P	Service kit	5060-A, MO & V models
C50402-P	Service kit	5078S, 5100S-C, 5120S, & SE models
C50403-P	Service kit	5150S, 5200S, & SE models
C50141	Shuttle assembly	5006, 5015, 5020, & MO, SE and V models
C50151	Shuttle assembly	5030-A, 5040-A, MO & V models
C50159	Shuttle assembly	5060-A, MO & V models
C50272	Shuttle assembly	5078S & SE models
C51600	Shuttle assembly	5100S-C, 5120S, & SE models
C50265	Shuttle assembly	5150S, 5200S, & SE models

Assembly Drawings

5078S, 5100S-C, 5120S, 5150S, 5200S

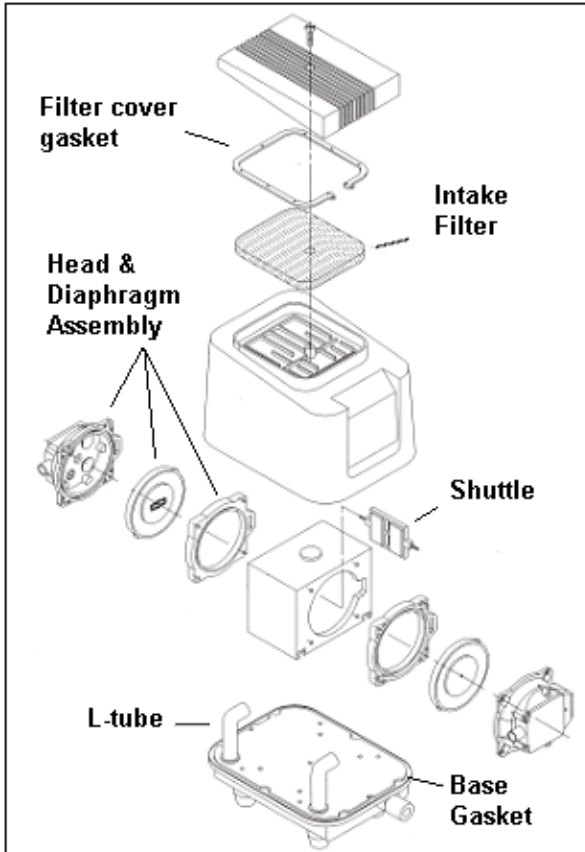

5030-A, 5040-A, 5060-A & V models

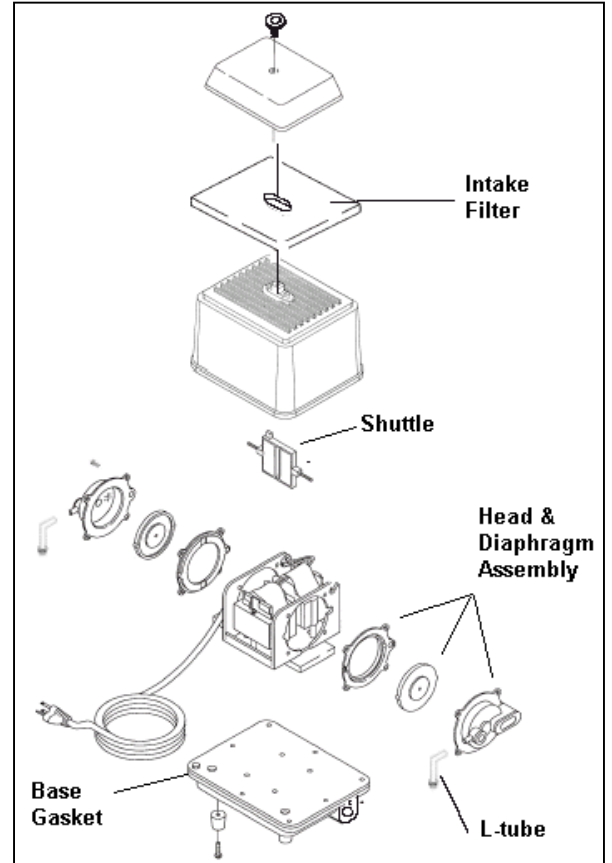

Notes:

1. MO and SE models have exploded views similar to those shown here but do not include the external housing and associated components such as L-tubes and gaskets. They also do not include power cords.
2. UL outdoor listed units typically have "OL" added to the model numbers shown in this document.

5006,
5015,
5020 & V
models

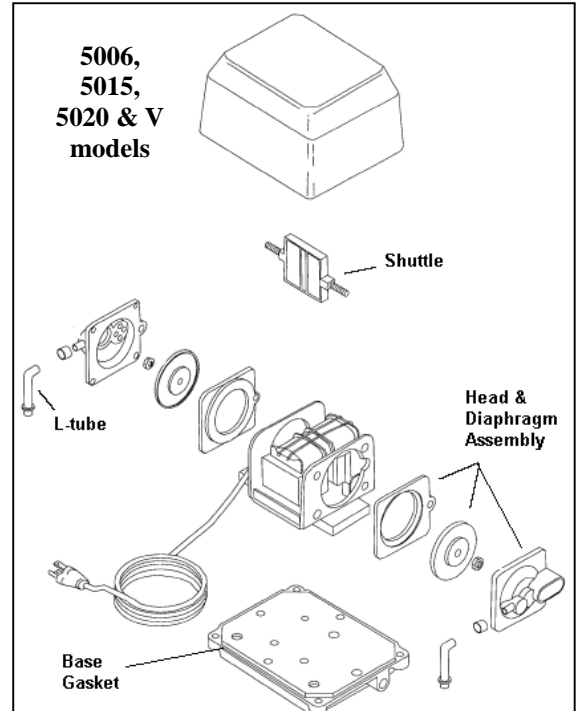



IMPORTANT NOTICE TO PURCHASER: WARRANTY AND EXCLUSIVE REMEDIES

- A. Thomas Products Division's compressors & vacuum pumps, when properly installed and under normal conditions of use, are warranted by Thomas Products Division to be free from defects in materials and workmanship at time of shipment. Warranty claims regarding products must be asserted within 18 months (the "warranty period") from date of manufacture encoded on the product or 12 months from the OEM product manufacture, whichever occurs first (unless otherwise agreed in writing or specified in a Thomas Products Division quotation).

The customer's exclusive remedy against Thomas Products Division, for a warranty claim or otherwise, shall be limited to repair or replacement of the subject product if it is shown to be defective in material and workmanship at the time of shipment, and then only if the claim is asserted during the warranty period. Thomas Products Division's maximum liability under this exclusive remedy shall never exceed the cost of the subject product and Thomas Products Division reserves the right, at its outside sole discretion, to refund the purchase price in lieu of repair or replacement, except for such warranty and exclusive remedy as stated (and except for the express warranty of title).

Thomas Products Division disclaims all other warranties with respect to its products, whether express or implied, and specifically disclaims under the implied warranties of merchantability and fitness for a particular purpose. In no event shall Thomas Products Division be liable to customer or third parties in warranty, contract, negligence, strict liability, or otherwise, for any damages, whether incidental or consequential, which are alleged to have been caused by one or more of our products, beyond the cost to the customer of the subject product or products, the exclusive remedy for any claim having been limited to repair or replacement as aforesaid.

- B. Because Thomas Products Division's warranties and remedies extend to our direct customers, the customer is not authorized to extend warranties on our behalf to anyone. Unauthorized extensions of warranties by the customer shall remain customer's responsibility.
- C. The customer is responsible for determining the suitability of our products for customer's use or resale, or for incorporating them into objects or for applications which customer designs, assembles, constructs, or manufactures.
- D. RETURNS POLICY

All sales are final. However, in some cases returns may be allowed. No products will be accepted for return without our written approval and unless accompanied by a properly authorized "Service Repair Order" (SRO) initiated by Thomas Products Division. Return freight must be PREPAID. For non-special or non-custom products accepted for return, transportation (if not prepaid) and a minimum restocking charge of 15% of the invoice value will be charged. Returned goods should be labeled as follows:

Example: SRO. 0000

Gardner Denver Thomas Products Monroe, Inc.
4601 Central Avenue
Monroe, LA 71203

Special or custom-made products, including units that are modified from standard units, cannot be returned for credit.

Service parts cannot be returned for credit.

CONTACT INFORMATION

Sales: ...920-457-4891 (Sheboygan, WI)

Service: ...318-338-5060 (Monroe, LA)