

Model CLFU, CVFU



PRO Cast

Submersible Non-clog Pump

EBARA International Corporation Standard Pump Division

Submersible Non-clog Pump

F e a t u r e s

- **Watertight cable entry system** prevents capillary action and protects against moisture; reduces maintenance costs
- **Heavy duty, high efficiency, air filled, Class F insulated, rated for 311°F with a 1.15 service factor** dissipates heat easily; thermal protection in each phase of windings protects; operates cooler with higher efficiencies; longer service life with lower operating costs
- **Single and double row thrust bearings** carries thrust loads with L-10 life of 60,000 hours; ensures long, dependable operation and lowers maintenance costs
- **Mechanically actuated float switch** provides early warning of mechanical seal failure; avoids costly motor repairs
- **Double mechanical seals — silicon carbide lower seals, carbon/ceramic upper** - hard faced upper and lower seals operate in an oil bath; providing longer service life and lower maintenance costs
- **High efficiency impellers** pass large solids with high outputs and reduces power consumption; impellers are optimized for hydraulic coverage; lowers operating costs
- **Replaceable wear components** maintains working clearances while reducing casing and volute costs

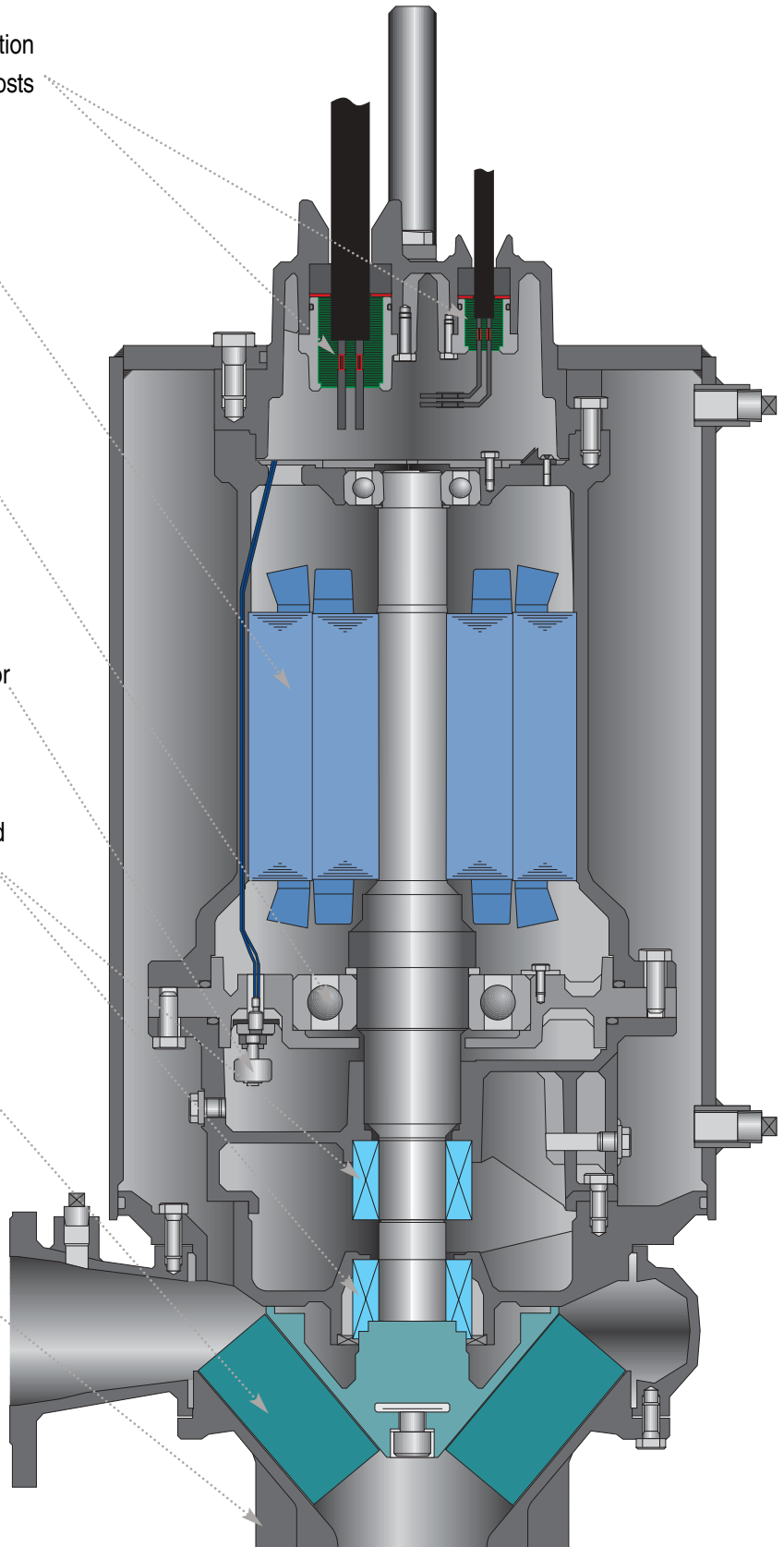

Submersible Non-clog Pump

CLF, CVFU standard specifications

- CLFU capacities to 550 GPM heads to 66 feet
- CVFU capacities to 425 GPM heads to 50 feet
- Horsepower range to 5 HP
- 1800 RPM
- Submergence to 65 feet
- Liquid sump temperatures to 104°F
- Spherical solids to 4"
- Stainless steel shaft
- 1.15 motor service factor
- 20 starts per hour
- L-10 bearing life of 60,000 hours
- Seal leak detection system
- Motor over temperature protection embedded in windings
- FM explosion proof, Class 1, Division 1, Group C, D available

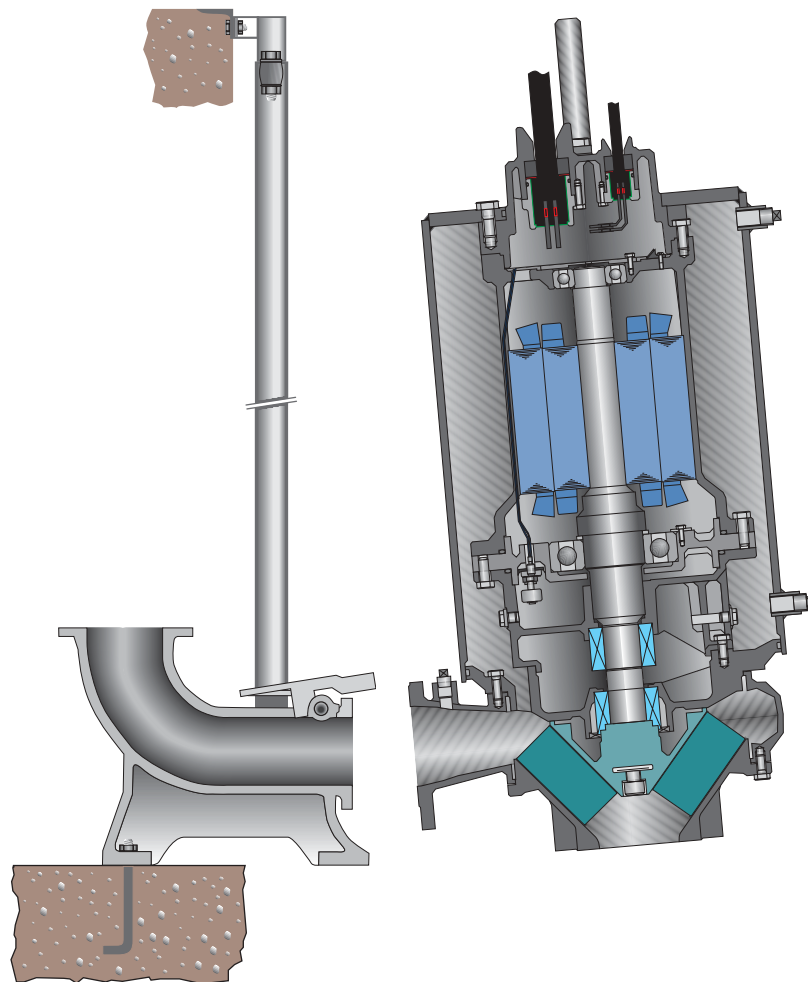

M o d e l C V F U a r r a n g e m e n t o p t i o n s

Model CVFU Vortex design

Vortex design is ideal for handling stringy materials without clogging

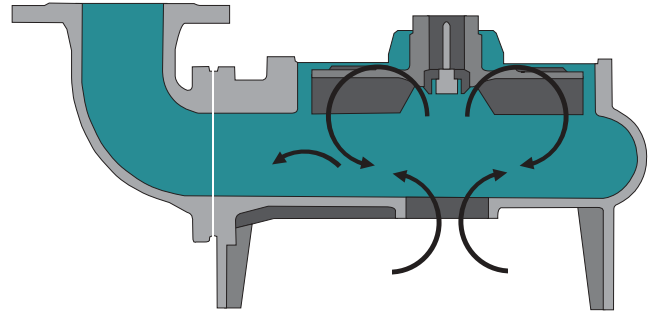

C a b l e e n t r y s y s t e m

- **Primary seal** — grommet (NBR)
- **Secondary sealing** — O rings (NBR)
- **Epoxy resin** — prevents capillary action
- **Cable gland** (grey cast iron)
- **Solid joint butt connector** (copper)

Note: Entry system is the same for both power and control cables.

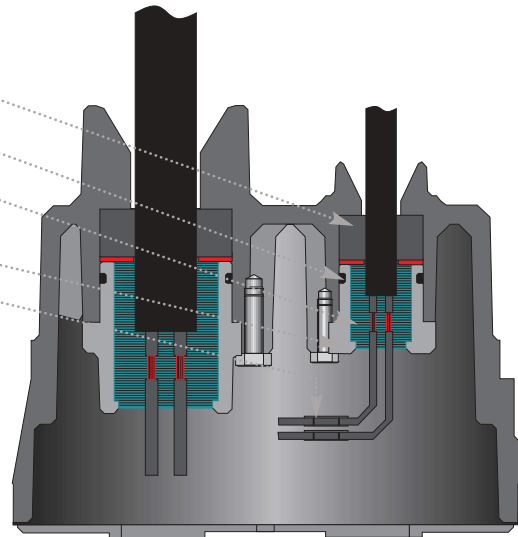

Materials

QDC & Slide Rail System

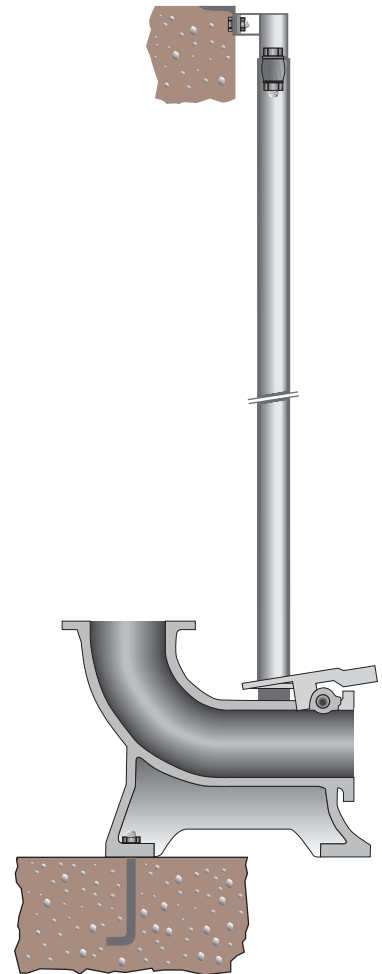
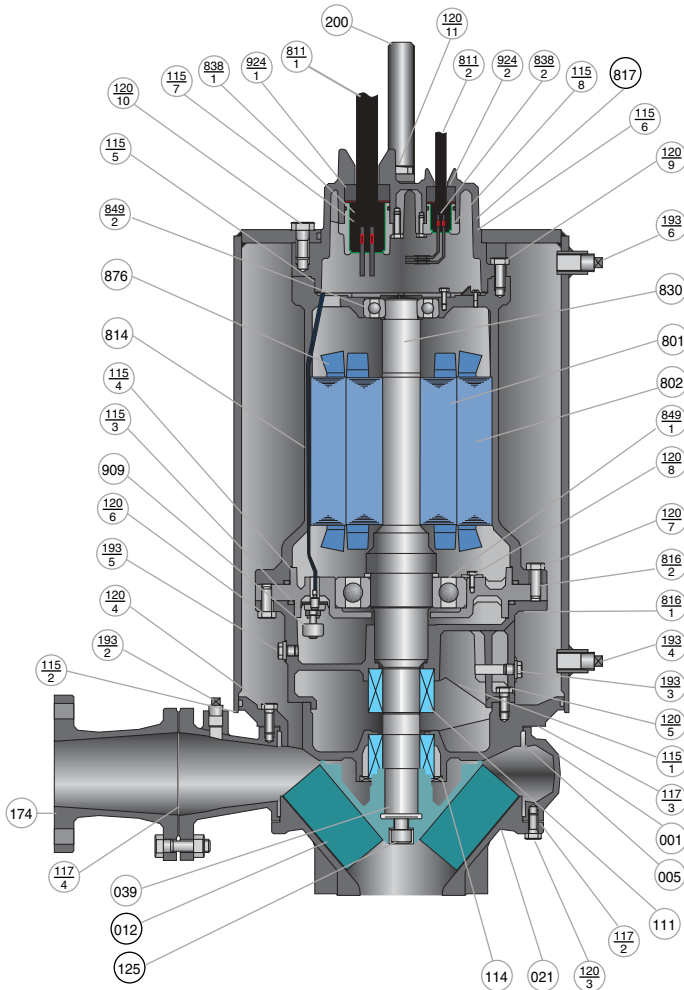

No.	Qty	Part Name	Material	ATM/AISI Code	No.	Qty	Part Name	Material	ATM/AISI Code
001	1	Casing	Cast Iron	A48 Class 30	120-11	2	Bolt	304 Stainless	AISI304
005	1	Intermediate Casing	Cast Iron	A48 Class 30	125	1	Bolt	304 Stainless	AISI304
'012	1	Suction Cover	Cast Iron	A48 Class 30	174	1	Discharge Pipe	Cast Iron	A48 Class 30
'021	1	Impeller	Cast Iron	A48 Class 30	193-2	1	Plug	304 Stainless	AISI304
039	1	Key	420 Stainless	AISI420	193-3	1	Plug	304 Stainless	AISI304
'111	1 set	Mechanical Seal	—		193-4	1	Plug	304 Stainless	AISI304
'114	1	Oil Seal	Rubber (NBR)		193-5	1	Plug	304 Stainless	AISI304
'115-1	1	O-ring	Rubber (NBR)		193-6	1	Plug	304 Stainless	AISI304
'115-2	1	O-ring	Rubber (NBR)		200	1	Lifting Hanger	Steel	A283 Grade D
'115-3	1	O-ring	Rubber (NBR)		801	1	Rotor	—	
'115-4	1	O-ring	Rubber (NBR)		802	1	Stator	—	
'115-5	1	O-ring	Rubber (NBR)		811-1	1	Power Cable	—	
'115-6	1	O-ring	Rubber (NBR)		811-2	1	Control Cable	—	
'115-7	1	O-ring	Rubber (NBR)		814	1	Motor Cover	Cast Iron	A48 Class 30
'115-8	1	O-ring	Rubber (NBR)		816-1	1	Bracket	Cast Iron	A48 Class 30
'117-2	1	Gasket			816-2	1	Bracket	Cast Iron	A48 Class 30
'117-3	1	Gasket			817	1	Bracket	Cast Iron	A48 Class 30
'117-4	1	Gasket			830	1	Shaft	403 Stainless	AISI403
120-3	8	Bolt	304 Stainless	AISI304	838-1	1	Washer	304 Stainless	AISI304
120-4	8	Bolt	304 Stainless	AISI304	838-2	1	Washer	304 Stainless	AISI304
120-5	4	Bolt	304 Stainless	AISI304	'849-1	1	Ball Bearing	—	
120-6	6	Bolt	304 Stainless	AISI304	'849-2	1	Ball Bearing	—	
120-7	6	Bolt	304 Stainless	AISI304	876	3	Motor Protector	—	
120-8	3	Bolt	304 Stainless	AISI304	909	1	Leakage Detector	—	
120-9	6	Bolt	304 Stainless	AISI304	924-1	1	Packing	Rubber (NBR)	
120-10	6	Bolt	304 Stainless	AISI304	924-2	1	Packing	Rubber (NBR)	

- †: Recommended spare parts.
- Quick Discharge Disconnect applies to Wet Pit installations only.
- Cooling jacket is used on dry pit configurations

Submersible Non-clog Pump

CLFU Selection Chart

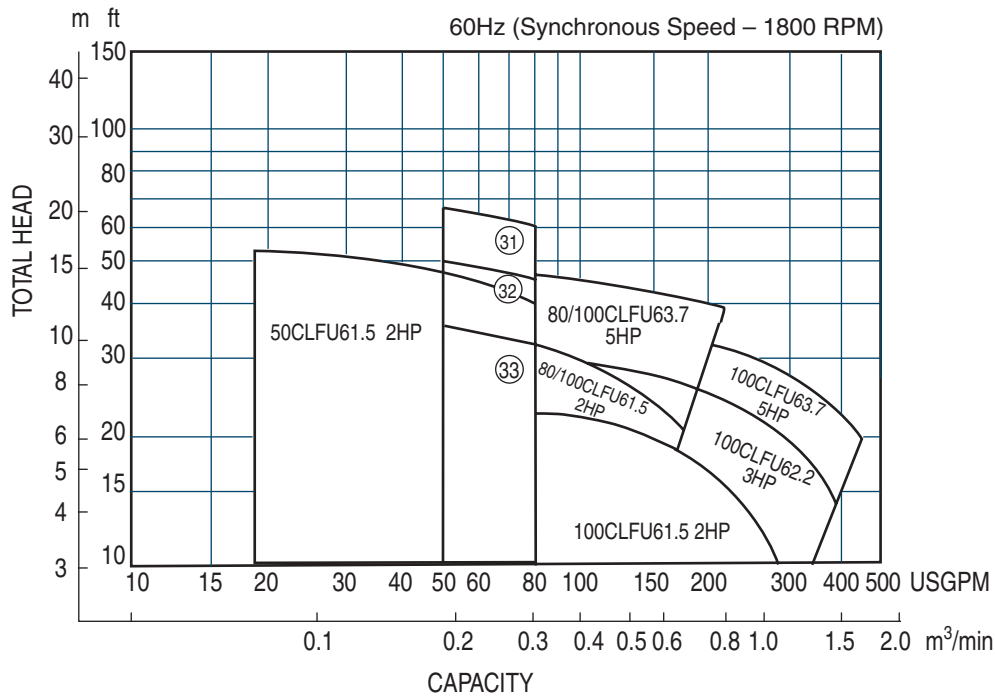

31	80CLMFU63.7	5HP
32	80CLMFU62.2	3HP
33	80CLMFU61.5	2HP

Applications

- Water
- Wastewater

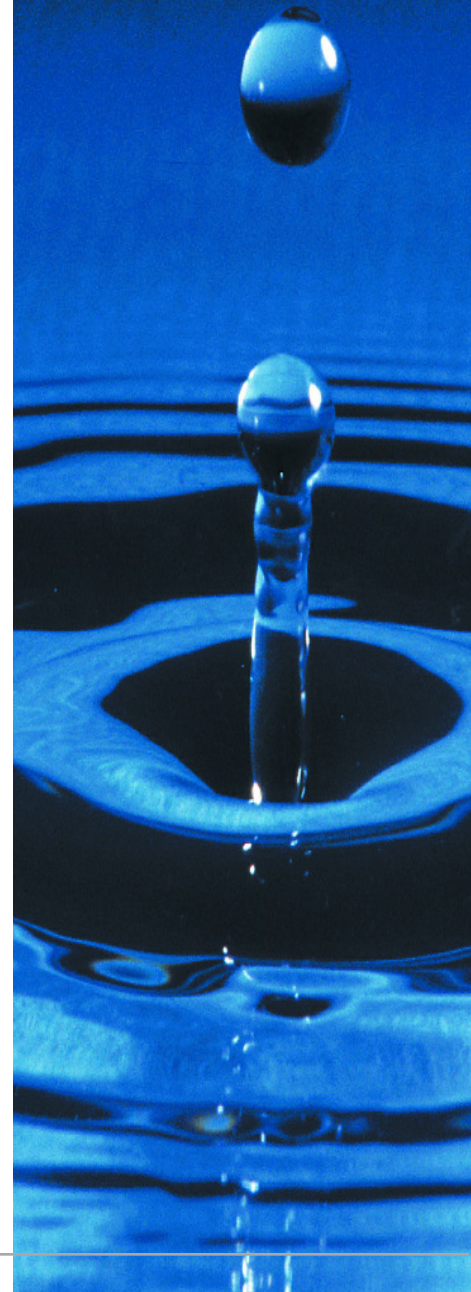

EBARA International Corporation

Standard Pump Division

1651 Cedar Line Drive • Rock Hill, SC 29730 • (t) 803 327 5005 • (f) 803 327 5097 • info@pumpsebara.com • www.pumpsebara.com

© 2000 EBARA International Corporation

EICCLFU 0300